



V E N U E S

---

**F U N C T I O N S &  
E V E N T S**

---

LET US CREATE SO YOU  
CAN CELEBRATE

# CHOOSE YOUR FUNCTION ROOM

## ROOM CAPACITY AND FLOOR PLAN

Our event rooms entertain 10 - 1,000 people and everything in between.

### ROOM HIRE PRICES

Room hire prices Monday - Friday 7am - 4pm or 4pm - 10pm

Saturday and Sunday prices on application

Note: All prices include 10% GST.

Prices & conditions are reviewed annually & subject to change

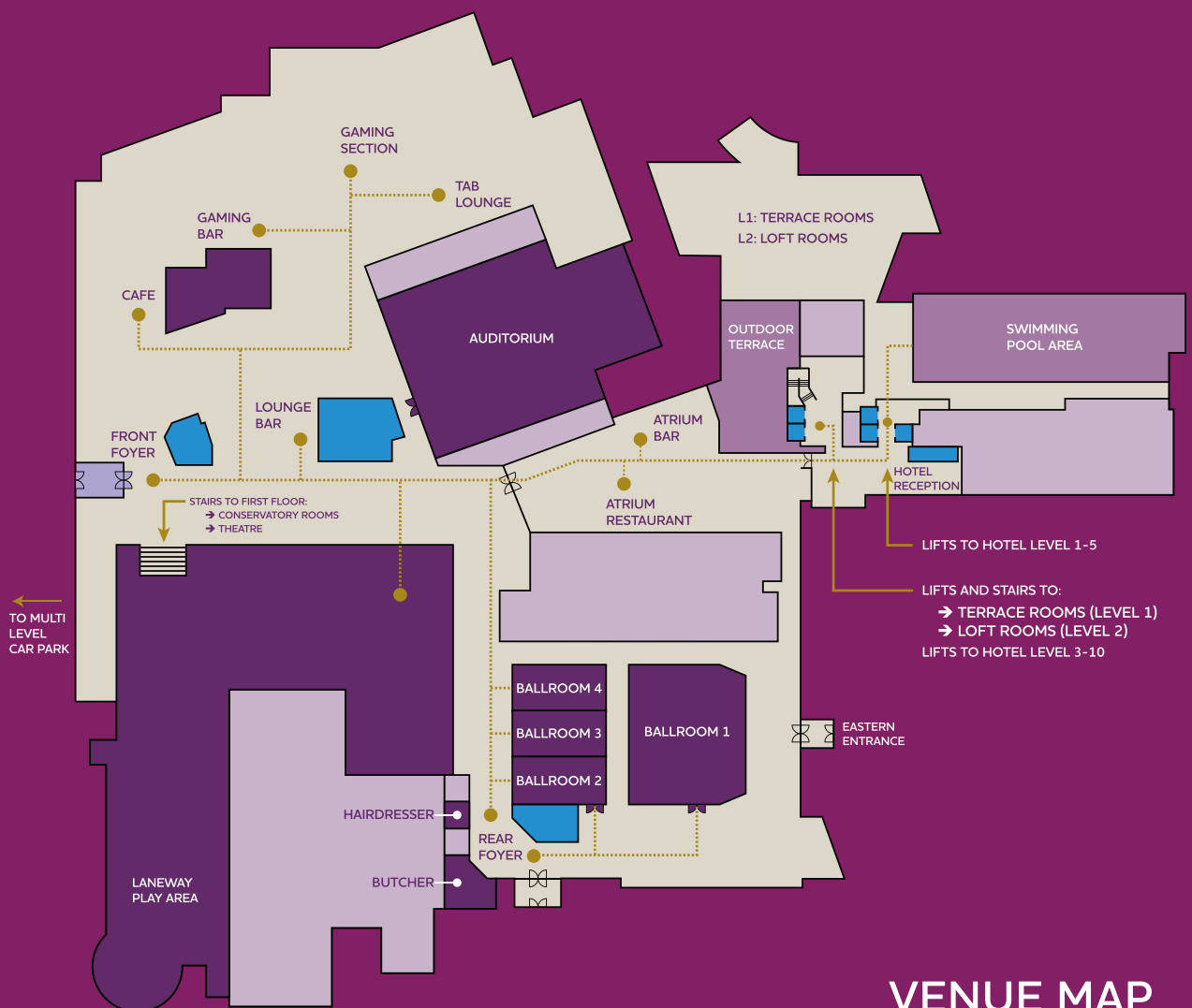

VENUE MAP

# FUNCTION ROOMS

## VERSATILE ROOMS

Our 14 modular event spaces can be configured to suit your needs perfectly. The Grand Ballroom looks spectacular when set up for a banquet; it has sliding acoustic partitions to create the ideal room size for your guest list. The Lo\ and Terrace rooms are perfect for smaller functions or meetings. All rooms have access to the latest technology.

## OUTDOOR SPACE

Set on 46 acres of land, we also have substantial outdoor event space for marquees, product demonstrations or children's entertainment.

## PRIVATE ENTRY AND FULLY ACCESSIBLE

Our event venue has its own private entry. Ground floor access makes our function rooms suitable for all ages and abilities, prams and wheelchairs.

## INCLUSIONS

Whichever room you hire, you will enjoy complimentary standard inclusions:

### SOCIAL

- » Premium table coverings
- » Napkins (various colour)
- » Cake table
- » Table decorations
- » Food service staff

### CORPORATE

- » Sky channels
- » White boards & flip chart
- » Lectern with microphone
- » EV and microphones
- » Video/TV/DVD
- » Large projector screens



	Theatre	Cabaret	Classroom	U-Shape	Boardroom	Banquet	Banquet Dance	Cocktail	Surface	Price Mon -Fri	Price Sat - Sun
Ballroom 1	520	240	200	50	-	300	230	400	650m <sup>2</sup>	\$2,500	\$5,500
Ballroom 2	70	48	25	25	20	70	-	80	105m <sup>2</sup>	\$560	\$600
Ballroom 2 & 3	150	64	50	30	30	90	70	150	210m <sup>2</sup>	\$800	\$800
Ballroom 3	70	48	25	25	20	70	-	80	105m <sup>2</sup>	\$560	\$600
Ballroom 3 & 4	150	64	50	30	30	90	70	150	202m <sup>2</sup>	\$800	\$800
Ballroom 4	70	48	25	25	20	70	-	80	97.5m <sup>2</sup>	\$560	\$600
Ballroom 2, 3 & 4	250	120	120	40	-	160	130	250	307m <sup>2</sup>	\$1,200	\$1,800
Grand Ballroom	1,000	400	500	-	-	600	550	700	1265m <sup>2</sup>	\$5,000	\$10,000
Terrace Room 1	48	24	27	18	18	40	-	60	57m <sup>2</sup>	\$370	\$400
Terrace Room 2	48	24	27	18	18	60	40	95	90m <sup>2</sup>	\$370	\$400
Terrace Room 1 & 2	94	64	60	30	-	110	90	155	147m <sup>2</sup>	\$560	\$800
Terrace Room 3	64	32	33	18	18	70	-	95	90m <sup>2</sup>	\$370	\$600
Terrace Room 4	-	-	-	-	-	-	-	40	36m <sup>2</sup>	\$190	\$200
Terrace Room 3 & 4	103	48	54	30	30	100	80	135	126m <sup>2</sup>	\$560	\$800
Terrace Room 5	36	16	18	12	12	20	-	55	53m <sup>2</sup>	\$370	\$400
Terrace Room 6	48	32	27	18	12	40	-	70	64m <sup>2</sup>	\$370	\$400
Terrace Room 5 & 6	96	64	54	30	30	80	60	125	117m <sup>2</sup>	\$560	\$800
Loft Room 1	34	16	18	15	12	20	-	40	38m <sup>2</sup>	\$200	\$200
Loft Room 2	50	24	27	18	12	40	-	60	58m <sup>2</sup>	\$370	\$400
Loft Room 3	57	24	27	18	12	40	-	60	58m <sup>2</sup>	\$370	\$400
Loft Room 2 & 3	108	72	54	30	-	80	60	120	116m <sup>2</sup>	\$560	\$800
Conservatory 1	60	50	30	25	20	60	40	90	98m <sup>2</sup>	\$560	\$600
Conservatory 2	60	50	30	25	20	60	40	90	100m <sup>2</sup>	\$560	\$600
Conservatory 1 & 2	120	100	50	30	30	120	80	180	198m <sup>2</sup>	\$800	\$1,200
Conservatory 3	40	20	22	15	12	30	-	50	42m <sup>2</sup>	\$370	\$370
Conservatory 4	40	20	22	15	12	30	-	50	42m <sup>2</sup>	\$370	\$370
Conservatory 2, 3 & 4	140	90	74	55	44	120	-	190	184m <sup>2</sup>	\$800	\$1,200
Conservatory 3 & 4	60	50	30	25	20	60	40	90	84m <sup>2</sup>	\$560	\$600
Conservatory 1, 2, 3 & 4	230	175	120	40	-	175	175	230	322m <sup>2</sup>	\$1,800	\$2,500
Conservatory 5	10	8	6	6	8	10	-	10	18m <sup>2</sup>	\$150	\$150
Conservatory 6	10	8	6	6	8	10	-	10	18m <sup>2</sup>	\$150	\$150
Conservatory 5 & 6	20	16	12	12	18	20	-	20	36m <sup>2</sup>	\$250	\$250
The Theatre	270	-	-	-	-	-	-	-	-	\$3,500	\$5,500
Auditorium	-	500	-	-	-	-	-	-	-		From \$4,000

Above pricing is for half day only. For full day pricing contact the events team  
Pricing is correct at time of publishing